

## 2015-18 Dodge Charger

Questions? Email us at [install@setina.com](mailto:install@setina.com)

- ✓ CAREFULLY READ INSTRUCTIONS BEFORE BEGINNING INSTALLATION.
- ✓ ALWAYS CHECK FOR FUEL LINES, BRAKE LINES, WIRING OR ANY OBSTRUCTIONS BEFORE DRILLING ANY HOLES!
- ✓ TO AVOID TAMPERING WITH FASTENERS ALWAYS PLACE WASHER AND NUTS AWAY FROM THE GUARDED AREA!!!

**⚠ IMPORTANT: SETINA PUSH BUMPER IS NOT COMPATIBLE WITH VEHICLES EQUIPPED WITH THE (Y66) ADAPTIVE CRUISE CONTROL OR FRONT PART ASSIST.**

### PB5 FENDER GUARD PARTS LIST

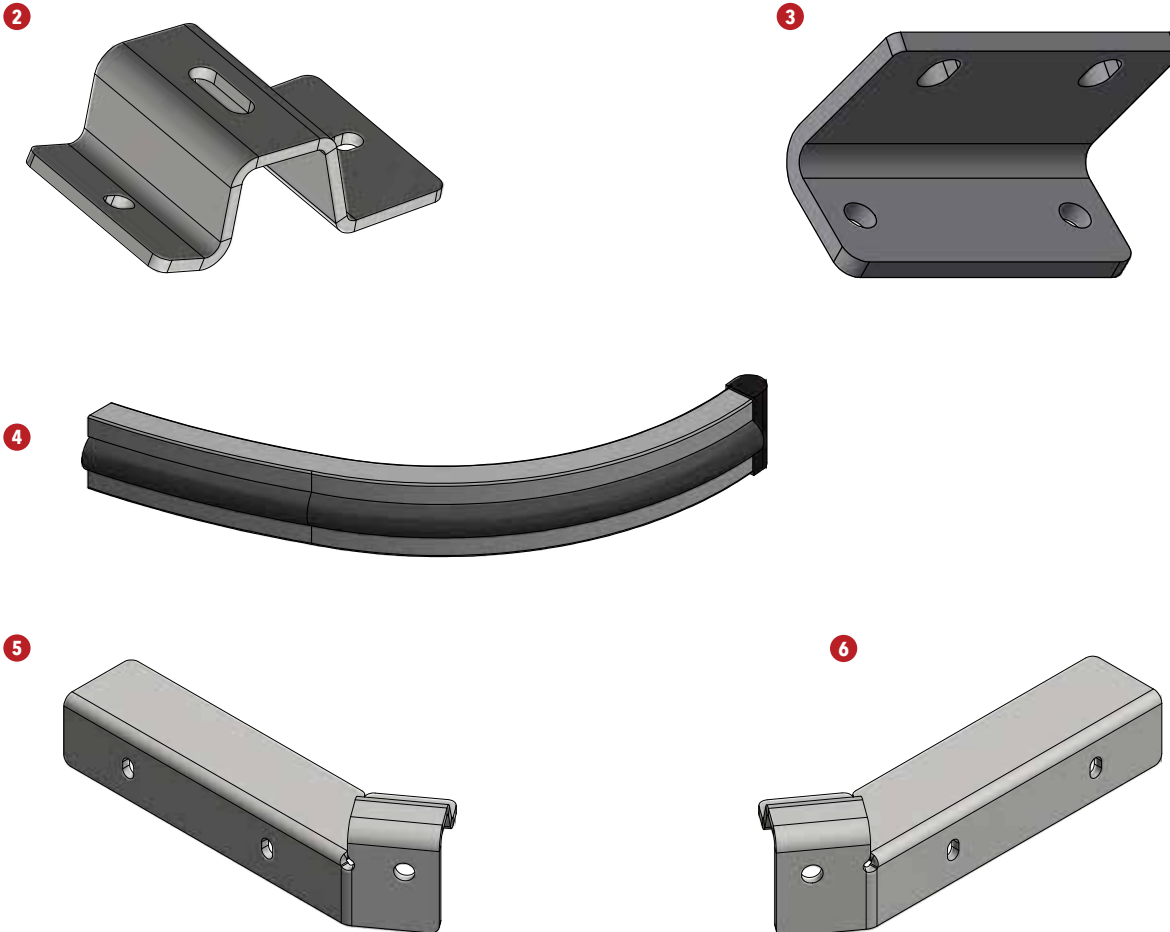

ITEM	QTY	PART #	DESCRIPTION	ITEM	QTY	PART #	DESCRIPTION
1	8	ALS4-616-312	3-8-16 Riv Nut (not pictured)	4	2	PB2831	PB400 Fender Guard - Both Sides
2	2	PB10832	400 Series Wrap - Outer Fascia Bracket - Both Sides	5	1	WB10834	Inner Wrap Bracket - Weldment - Driver Side
3	2	PB10833	400 Series - Wrap to Sideplate Bracket - Both Sides	6	1	WB10835	Inner Wrap Bracket - Weldment - Passenger Side

### 2015-18 Dodge Charger

Questions? Email us at [install@setina.com](mailto:install@setina.com)



**IMPORTANT: BOLT BAG MAY CONTAIN EXTRA FASTENERS**

**BOLT BAG BB8895**

ITEM	QTY	PART #	DESCRIPTION
1	2	37C100HFU8	3/8" x 1" HHCS Flanged
2	2	37NWUSY	3/8 Flat Washer
3	2	50C275HCS8	1/2" x 2.75" Hex Head
4	2	50CNFU8	1/2" Wizlock
5	2	WF4532	3/8 Wizlock w-Wire
6	2	PB2781-1.5	1.5" Outer Spacer
7	4	33012	1/2" Fender Washer
8	6	37CNFU8	3/8" Wizlock
9	14	37C125HFU8	3/8" x 1.25" HHCS Flanged

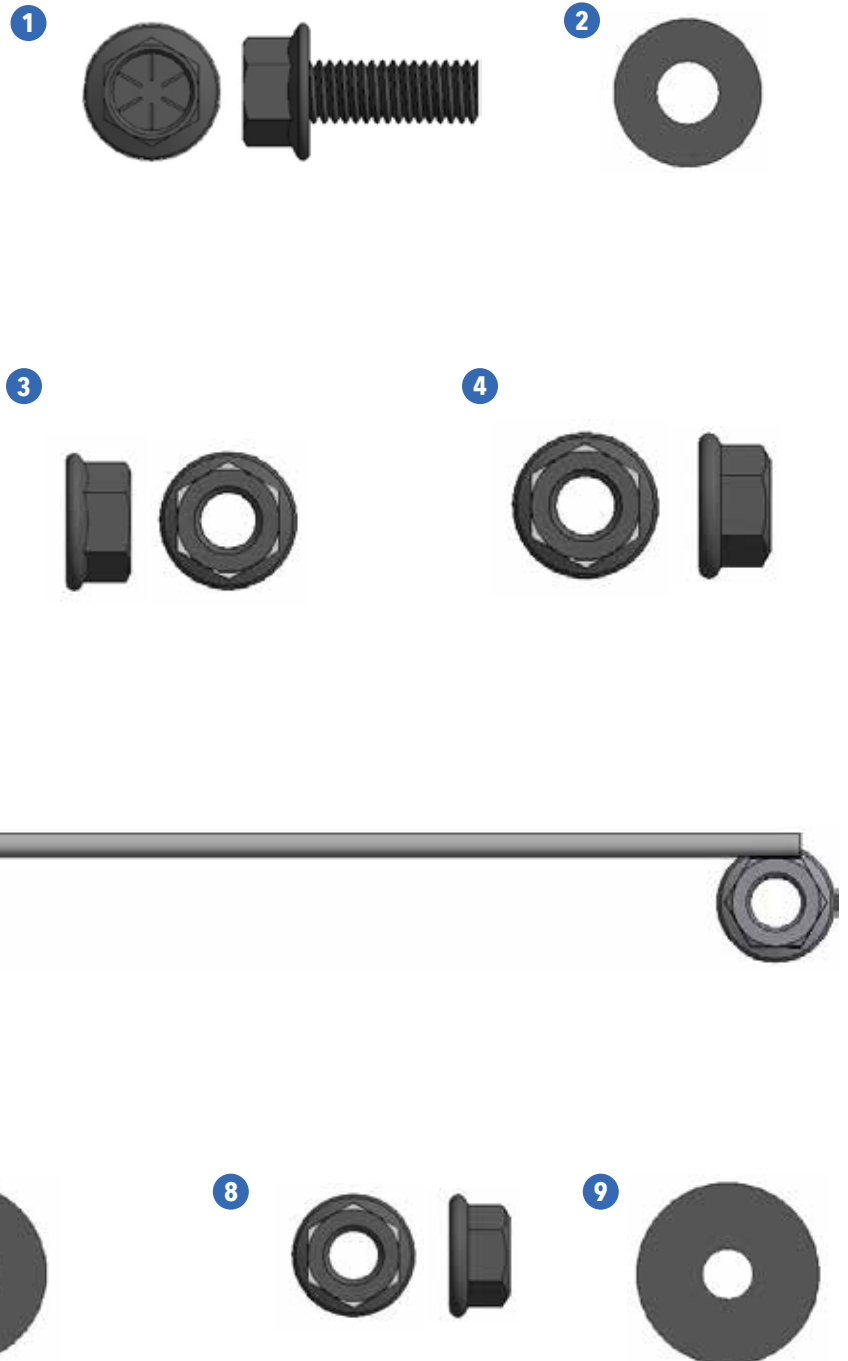

### 2015-18 Dodge Charger

Questions? Email us at [install@setina.com](mailto:install@setina.com)

#### INSTALL GUIDE

Figure 1

STEP 1

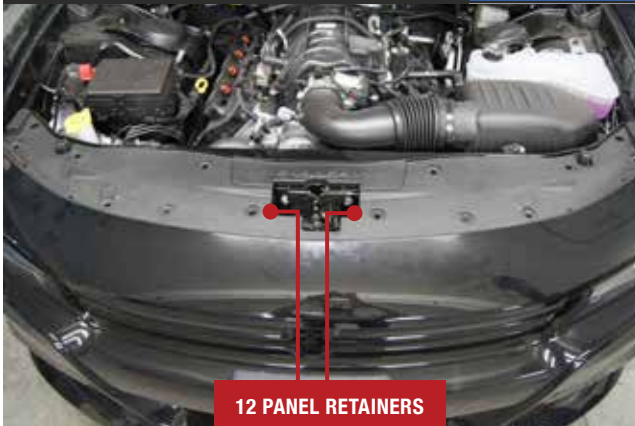

#### STEP 1 - Instructions

Begin by removing the plastic push plugs & the Charger cover.

**SEE FIGURE #1**

Figure 2

STEP 2



#### STEP 2 - Instructions

Locate and remove the 10mm fasteners from both sides of the vehicle securing the fascia to the fender.

**NOTE: Driver Side shown**

**SEE FIGURE #2**

Figure 3

STEP 3



#### STEP 3 - Instructions

Move to the wheel wells, remove the panel retainers securing the well cover to the fender. Remove the (2) retainers securing the upper center of the cover. Repeat on passenger side.

**NOTE: Driver Side shown**

**SEE FIGURE #3**

Figure 4

STEP 4



#### STEP 4 - Instructions

Move to the lower portion of the well cover. Remove the 7mm fasteners securing the brake vents. Repeat for the passenger side.

**NOTE: Driver Side shown**

**SEE FIGURE #4**

### 2015-18 Dodge Charger

Questions? Email us at [install@setina.com](mailto:install@setina.com)

#### INSTALL GUIDE

Figure 5

STEP 5



#### STEP 5 - Instructions

Remove the 7mm fasteners securing the fascia to the underside of the vehicle.

**SEE FIGURE #5**

Figure 6

STEP 6



#### STEP 6 - Instructions

Locate and remove the (2) 10mm fasteners, securing the fascia to the fender within the vehicle.

**NOTE: Driver Side shown**

**SEE FIGURE #6**

Figure 7

STEP 7



#### STEP 7 - Instructions

Remove fascia slowly, reach in and disconnect the harness from the side markers. Remove the fascia completely.

**NOTE: Driver Side shown**

**SEE FIGURE #7**

Figure 8

STEP 8



#### STEP 8 - Instructions

Place the PB5 inner bracket against the inner bumper of the vehicle. Align the inner edge of the bracket to the large obround. Mark the (2) mounting holes onto the vehicle's bumper. Repeat for passenger side.

**NOTE: Driver Side shown**

**SEE FIGURE #8**



### 2015-18 Dodge Charger

Questions? Email us at [install@setina.com](mailto:install@setina.com)

#### INSTALL GUIDE

Figure 9

#### STEP 9



#### STEP 9 - Instructions

Remove the mount PB5 inner bracket. Drill the marks using a 25/64" drill bit. Repeat for passenger side.

**SEE FIGURE #9**

Figure 10

#### STEP 10

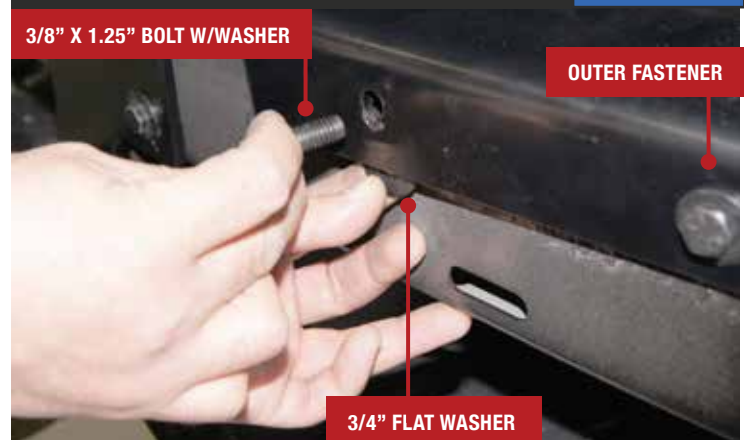

#### STEP 10 - Instructions

Secure the outer mount point loosely using the 3/8" x 1" flanged bolt, 3/8" fender washer and 3/8" wizlock. Pull the inner edge of the bracket, slide a 3/8" flat washer behind the inner mounting point. Insert the 3/8" x 1.25" flanged bolt with washer through the mount point.

**NOTE:** Driver Side shown

**SEE FIGURE #10**

Figure 11

#### STEP 11



#### STEP 11 - Instructions

Feed the wired nut through the obround in the bumper. Look down the end of the bumper to align the bolt and nut. Tighten down the fasteners. Remove wire from nut. Repeat for passenger side.

**NOTE:** Install push bumper brackets at the time if not installed

**SEE FIGURE #11**

Figure 12

#### STEP 12



#### STEP 12 - Instructions

Move the backside of the fascia. Remove the plastic strip indicated in Figure 12. Return the fascia to the vehicle. Repeat for passenger side.

**SEE FIGURE #12**

### 2015-18 Dodge Charger

Questions? Email us at [install@setina.com](mailto:install@setina.com)

#### INSTALL GUIDE

Figure 13

STEP 13



#### STEP 13 - Instructions

Reach in through the wheel well and mark the PB5 mount hole onto the inside of the fascia. Remove the fascia and drill the mark using a step bit to accommodate the spacer.

**NOTE:** Passenger Side shown

**SEE FIGURE #13**

Figure 14

STEP 14



#### STEP 14 - Instructions

Secure the side plate attachment bracket to the front of the wrap loosely with the provided 3/8" x 1.25" flanged bolt and 3/8" flat washer. Secure the outer fascia bracket to the bracket end of the wrap in the same manner.

**NOTE:** Install push bumper at this time

**SEE FIGURE #14**

Figure 15

STEP 15

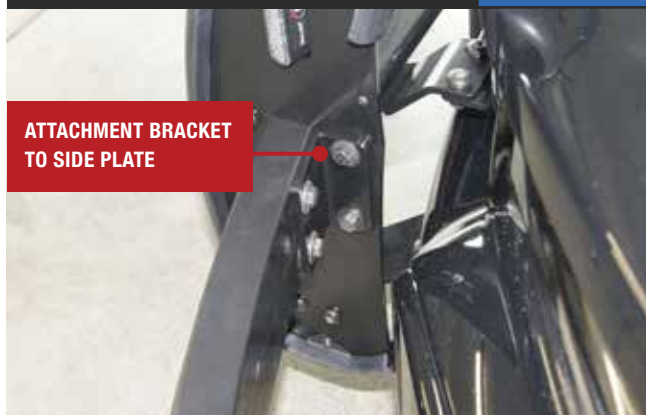

#### STEP 15 - Instructions

Lift the assembled wrap to the side plate. Align the mounting holes on the attachment bracket to the mounting points on the side plate. Secure loosely with the provided 3/8" x 1.25" flanged bolts, 3/8" flat washer and 3/8" wizlocks. Repeat for passenger side.

**NOTE:** Driver Side shown

**SEE FIGURE #15**

Figure 16

STEP 16



#### STEP 16 - Instructions

Move to the back end of the wrap. Slide the 1/2" x 2.75" Hex bolt with 1/2" washer through the outer fascia bracket. Slide the 1.5" spacer between the outer and inner bracket. Secure through the wheel well using a 1/2" washer and 1/2" nyloc. Repeat for passenger side.

**NOTE:** Driver Side shown

**SEE FIGURE #16**

### 2015-18 Dodge Charger

Questions? Email us at [install@setina.com](mailto:install@setina.com)

#### INSTALL GUIDE

Figure 17

STEP 17



#### STEP 17 - Instructions

Level bumpers and wraps. Tighten fasteners to complete the install.

**NOTE:** *Install push bumper at this time*

**SEE FIGURE #17**